



Superb Two-Bedroom Residence in Hereford House

OVINGTON GARDENS

CHELSEA, SW3

£1,000 per week

**BERKSHIRE
HATHAWAY**
HOMESERVICES

LONDON

PROPERTY DETAILS

Guide Price £1,000 per week	Square Footage 750
Council Tax Band G	EPC Rating C

A beautifully presented two-bedroom apartment located in the well-regarded Hereford House on Ovington Gardens, right in the heart of Knightsbridge. This attractive property is just moments from Harrods, Sloane Street and the excellent restaurants, cafés and boutiques of Brompton Road.

The flat offers a bright and spacious reception room with large windows and generous ceiling height, creating an inviting setting for both everyday living and entertaining. The separate kitchen is smartly designed with modern fittings and good storage, while both bedrooms are well proportioned and enjoy a peaceful outlook. The bathroom is finished in a clean, contemporary style, complementing the overall presentation of the apartment.

Hereford House is a well-maintained period building, ideally positioned for Knightsbridge Underground Station, the open spaces of Hyde Park and the museums and cultural landmarks of South Kensington. This property makes an ideal home or London base in one of the capital's most prestigious and sought-after locations.

FEATURES

- Two Bedrooms
- Two Reception Rooms
- Two Bathrooms
- Lift
- Large Windows
- Wood Flooring
- Bright and Spacious
- Ceiling Height

LOCATION



KNIGHTSBRIDGE LETTINGS

55-57 SLOANE AVENUE, SW3 3DH

020 7235 9641

lettings.knightsbridge@bhhs-london.com



FLOORPLAN

Hereford House,
Ovington Gardens, SW3
Approximate Gross Internal Area
70.35 sq m / 757 sq ft
(CH = Ceiling Heights)

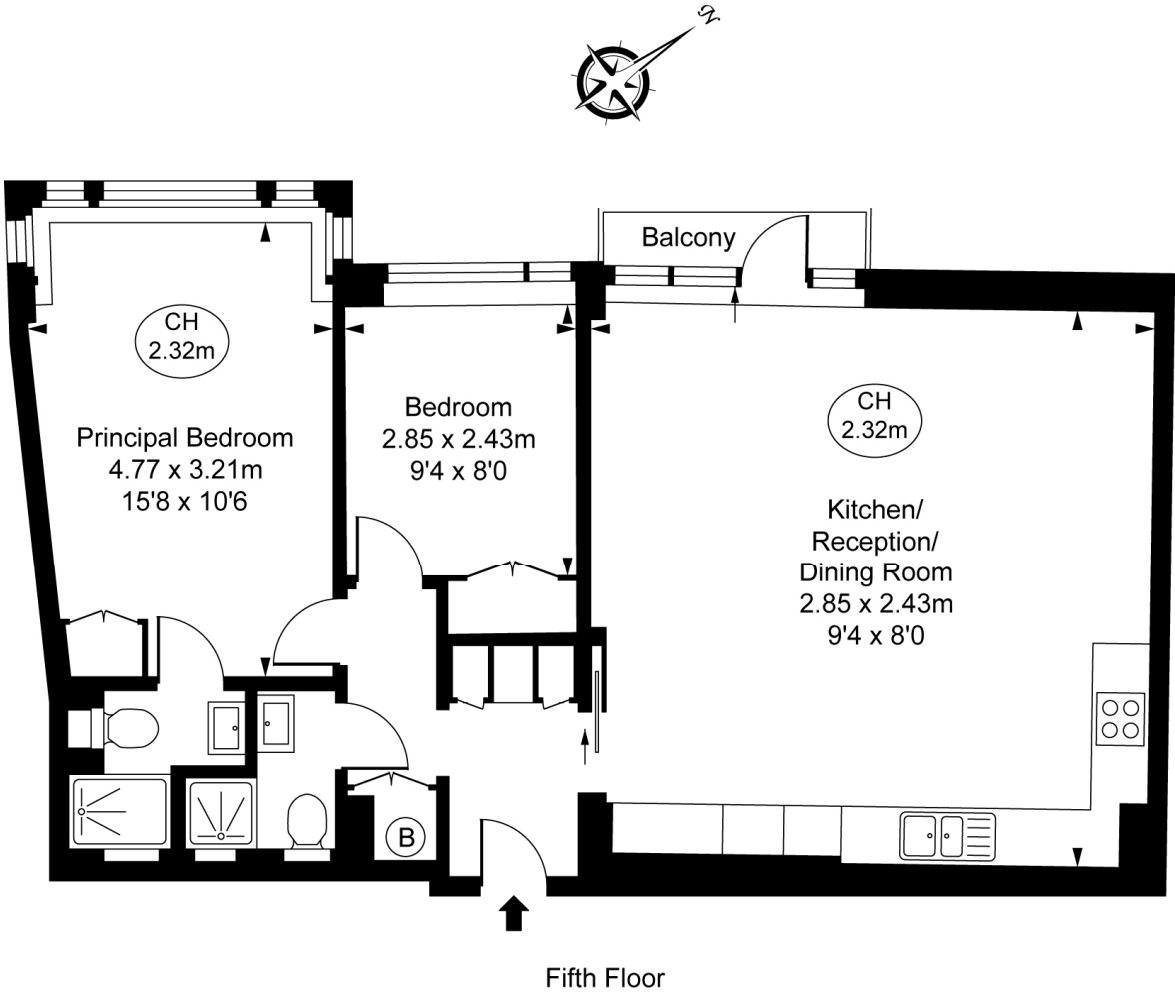

This plan is not to scale. It is for guidance and not for valuation purposes.
All measurements and areas are approximate only, and have been prepared in accordance with the current edition of the RICS Code of Measuring Practice.
© Fulham Performance